

MOISTURE-ELIMINATING RAINSCREENS

For Premium Sidewall Protection

What Is a Rainscreen?



A rainscreen is a wall system with an airspace between the exterior cladding and wall sheathing that drains and ventilates moisture. Rainscreens are recognized by research and building science as the best method of wall construction in wet coastal climates.

A rainscreen is your best defense against the negative effects of moisture that attack a home's wall system. Wind-driven rain from the outside, moisture vapor from the home's interior, and corrosive surfactants that leak from certain types of siding usually remain trapped behind the siding.

Left alone, this unvented moisture can negatively affect the performance of the wall assembly as well as lead to mold and mildew, a potential health hazard.

How does Home Slicker help?

Prior to the introduction of Home Slicker, furring strips under cladding were the only historical building practice available to help alleviate the moisture problem in wall assemblies. Home Slicker was designed to provide an easy-to-install continuous ventilation and drainage space that outperforms furring strips.

Home Slicker solves the moisture problem by effectively draining and venting moisture from behind various cladding systems, including wood shingles and shakes, wood siding, stucco/stone veneer, fiber-cement siding, vinyl siding, and brick veneer. Home Slicker's unique three-dimensional matrix provides a continuous space for drying, channels for drainage, a thermal break and pressure equalization.

Home Slicker. Moisture escapes quickly – before it does damage.



Installation Instructions

Home Slicker® and Home Slicker® 10

Home Slicker and Home Slicker 10 are Benjamin Obdyke's patented, moisture eliminating rainscreens. Home Slicker 10 is designed to meet 10mm code requirements in Canada.

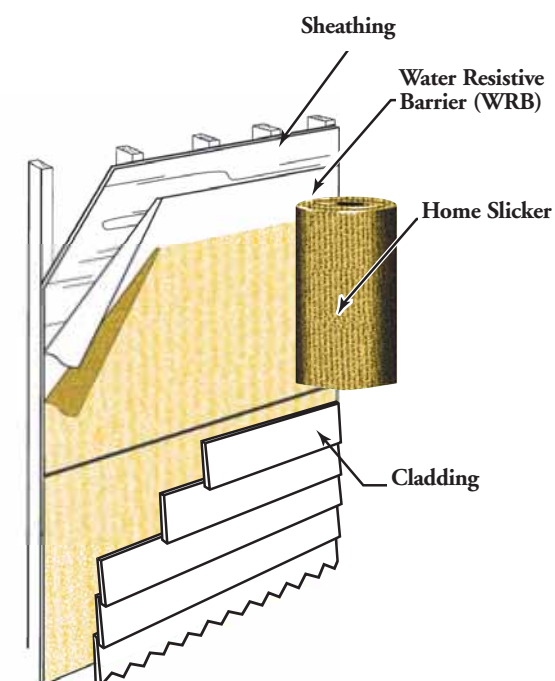

1. Install sidewall sheathing material over studs and apply water resistive barrier per manufacturer's instructions. Install Home Slicker after windows are properly installed and flashed. Refer to window installation details on flashing integration.*
2. Roll out Home Slicker wherever siding or cladding will be applied with channels running vertically. Do not stretch Home Slicker – it should lie flat against the wall. Nail or staple (min. 1/2" staple) every 3 square feet. (For stucco or stone applications, install an additional water resistive barrier over the exposed channels of Home Slicker.)

3. Butt edges of new rolls or new courses together—do not overlap layers of Home Slicker. Cover entire wall surface wherever siding materials will be installed.
4. Install siding or cladding system over wall surface per manufacturer's installation instructions. Allow for thickness of Home Slicker in nail selection.* Do not overnail.

***Note:** Refer to information in the Home Slicker Application and Architectural Drawings available online at www.benjaminobdyke.com.



Courtesy of APA – The Engineered Wood Association



Courtesy of APA – The Engineered Wood Association

Installation Instructions

Home Slicker® Plus Typar® and Home Slicker® Plus Super Jumbo Tex® 60 Minute

Home Slicker Plus Typar and Home Slicker Plus Super Jumbo Tex 60 Minute are cost-effective, labor and material saving, moisture eliminating rainscreens and water resistive barriers. Home Slicker Plus Typar contains the patented Home Slicker three-dimensional matrix bonded to Typar, a premium residential and commercial grade housewrap. Home Slicker Plus Super Jumbo Tex 60 Minute also contains the patented Home Slicker three-dimensional matrix attached to a premium 60 minute building paper.

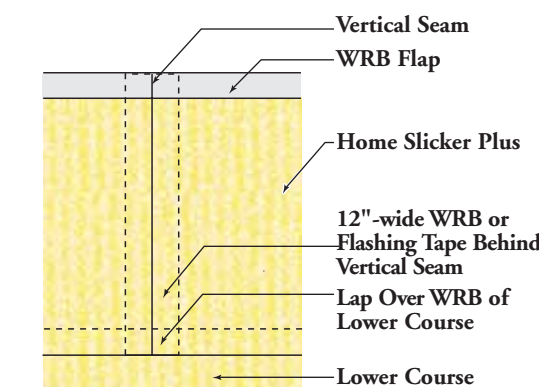
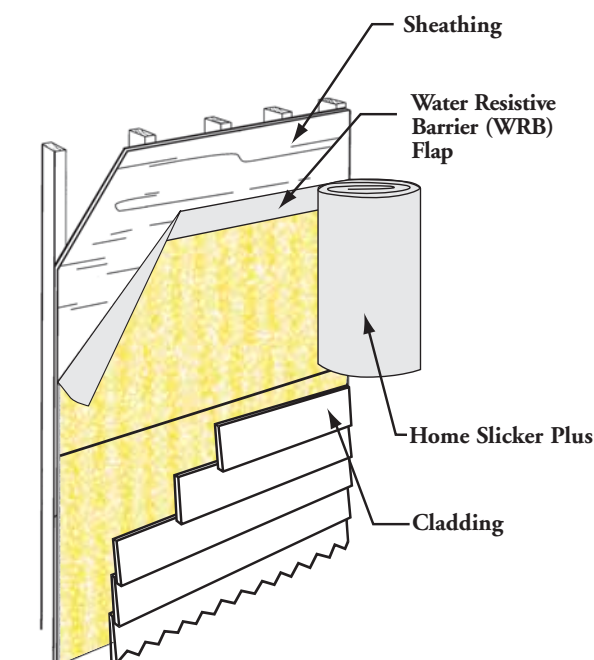

1. Install sidewall sheathing material over studs. Install Home Slicker Plus after windows and doors are properly installed and flashed. Refer to window installation for details on flashing integration.*
2. Roll out Home Slicker Plus wherever siding or cladding will be applied with channels running vertically and the extra water resistive barrier (WRB) flap on top. (For stucco or stone applications, install an additional WRB over the exposed channels of Home Slicker Plus. For Home Slicker Plus Super Jumbo Tex 60 Minute alternate installation instructions for stucco or stone, visit www.benjaminobdyke.com.) Home Slicker Plus must roll out left to right. Nail or staple (min. 1/2" staple) every 3 square feet.
3. To create a vertical seam between rolls, install a 12"-wide WRB, such as Typar or Super Jumbo

Tex 60 Minute, behind vertical joint. The bottom of the flashing should be lapped over the WRB flap of the lower course. Optionally, attach flashing tape to the back of the WRB at the end of each roll. Center the flashing so half extends past the roll's end with the sticky side out. Butt the next roll and seal onto other half of flashing. Proceed up the wall. The higher course should overlap the WRB on the lower course. Butt edges of Home Slicker matrix together with the WRB lapped underneath the new roll.

4. Install siding or cladding system over wall surface per manufacturer's installation instructions. Allow for thickness of Home Slicker Plus in nail selection.* Do not overnail.

***Note:** Refer to information in the Home Slicker Application and Architectural Drawings available online at www.benjaminobdyke.com.

FEATURES & BENEFITS



FEATURES

- Rolls out quickly over entire wall surface
- Creates a continuous airspace between cladding and sheathing
- Drains wind-driven rain that gets behind siding/cladding
- Ventilates behind cladding to remove moisture vapor and dampness

BENEFITS

- Installs faster and with fewer complications than with furring strips
- Allows wall assembly to dry, extending the service life of all components
- Water resistive barrier is separated from wood and stucco surfactants that can degrade performance
- Helps keep water resistive barrier from “ballooning” under wind pressure and pulling away from fasteners
- Equalizes or moderates pressure across the cladding, reducing opportunity for wind-driven rain to get behind cladding
- Wall is kept drier, reducing opportunity for mold growth

PAINTS & STAINS

Home Slicker has been recognized by many major paint/stain manufacturers to help preserve the finish and ensure proper service life of paints and stains.



SURFACTANTS

By separating the housewrap and building paper from the siding, Home Slicker significantly reduces surfactant contact that can degrade performance.

SHEATHING

As with most building materials, moisture can attack and damage sheathing, compromising the structural integrity of the wall assembly.



Home Slicker allows an escape for this moisture, thereby lessening the opportunity for moisture damage to occur.

WATER RESISTIVE BARRIERS (WRBs)

Housewraps and building papers are subject to a number of factors, including unventilated moisture, wind pressure, and surfactant exposure, that can degrade and weaken their ability to perform. Home Slicker creates separation between the water resistive barrier and cladding to provide airspace to facilitate drainage and eliminate moisture.



Courtesy of APA – The Engineered Wood Association

Specifications

	Home Slicker	Home Slicker 10
Specifications		
Width	39.37 in.	39.37 in./1m
Length	46.5 ft.	38.5 ft./11.73m
Coverage	150 sq. ft.	125 sq. ft./11.6m ²
Thickness	.25 in.	.44 in./11mm
Weight	7.2 lbs. per roll	7.3 lbs. per roll
Matrix Design	2 channels per in.	1.5 channels per in.
UV Exposure	30 days (max)	30 days (max)
Warranty	50-Year Limited	50-Year Limited

Specifications are subject to change.

	Home Slicker Plus Typar	Home Slicker Plus Super Jumbo Tex 60 Minute
Specifications		
Width of Home Slicker	39.37 in.	36 in.
Width of WRB	45 in.	40 in.
Width of flap	4 in. (min)	4 in. (min)
Length	61.5 ft.	33 ft.
Coverage	200 sq. ft.	100 sq. ft.
Thickness	.26 in.	.26 in.
Weight	15 lbs. per roll	13 lbs. per roll
Matrix Design	2 channels per in.	2 channels per in.
UV Exposure	30 days (max)	30 days (max)
Warranty	50-Year Limited	10-Year Limited

Specifications are subject to change.

To reach a Customer Service Representative, call 800-346-7655 or visit www.benjaminobdyke.com.

BENJAMIN OBDYKE

BENJAMIN OBDYKE INCORPORATED • 199 Precision Drive • Horsham, PA 19044 • www.benjaminobdyke.com

Sales: 800-523-5261 • Customer Service: 800-346-7655 • Fax: 215-672-3731 • E-mail: info@benjaminobdyke.com

Home Slicker® is a registered trademark of Benjamin Obdyke Incorporated.
Typar® is a registered trademark of BBA Fiberweb™ Reemay, Incorporated.
Super Jumbo Tex™ 60 Minute is a registered trademark of Fortifiber Building Systems Group.

US Patent #6,594,965
© 2005 Benjamin Obdyke Incorporated
LTHSFB Printed 6/05

HOME SLICKER®

HOME SLICKER® 10

HOME SLICKER® PLUS TYPAR®

HOME SLICKER® PLUS SUPER JUMBO TEX® 60 MINUTE



HOME SLICKER®

HOW EXTERIOR WALLS STAY DRY ON THE INSIDE



WATER RESISTIVE BARRIER